



### Adding Custom Links to the ieMR Toolbar

You can add icons linked to programs to the *ieMR Toolbar*. Once added these stay customised to your login.

#### Adding a custom link

1. Click on the Chevron  next to the icon row you'd like to add the link within on the *ieMR Toolbar*



2. You will see  in the row if there are other icons present in the row but aren't displayed
3. From the drop-down menu select *Add or Remove Buttons* then click *Customize*

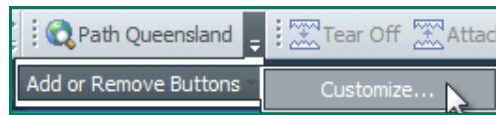

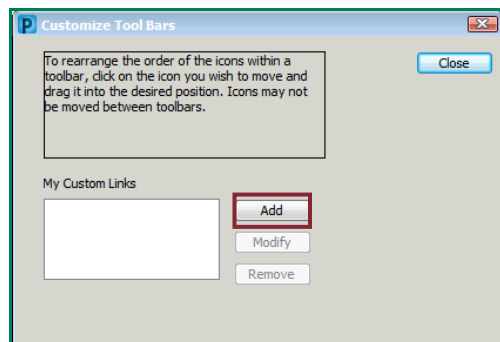

4. From the *Customize Tool Bars* window click *Add*

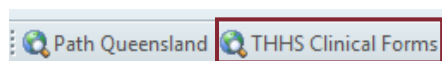
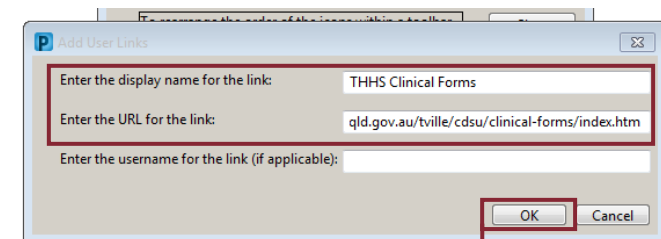

5. Enter a display name for the link and then enter the URL for the link or select from the list below
6. Click *OK*
7. Your customised link will now display in the *ieMR Toolbar*



8. If your new icon isn't visible the bar may be too small, click  to find it
9. You can also resize or move the row by clicking and holding  and dragging it to your desired length or position

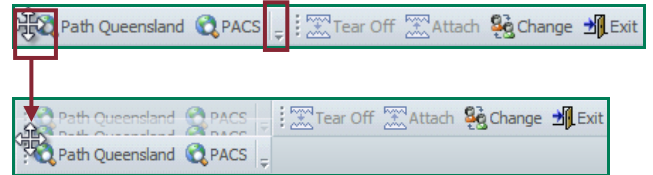

#### Commonly used site and application URLs

THHS Clinical Forms

<http://qheps.health.qld.gov.au/tville/cdsu/clinical-forms/index.htm>

QHEPS Enterprise Applications links

<http://qheps.health.qld.gov.au/masters/appslst.htm>

PACS XERO – Medical Imaging and Radiology Viewer

<https://entpacsxero.health.qld.gov.au/>

EDS – Enterprise Discharge Summary

<https://eds.health.qld.gov.au/User/Login?returnUrl=%2FEDS%2FHome>

EDIS – Emergency Department Information System

<http://thinweb.health.qld.gov.au/EDISXenApp5/EDISPP.html>

PFM – Patient Flow Manager

<http://thsd-pfm.nth.health.qld.gov.au:8082>

CIMHA – Consumer Integrated Mental Health Application

<https://cimha.health.qld.gov.au/Login.aspx>

Metavision

<https://cimha.health.qld.gov.au/Login.aspx>

Maternity and Neonatal Clinical Guidelines

<https://www.health.qld.gov.au/qcg/default.asp>